

# TAVISTOCK PLACE

4

BA (Hons) Fashion Media & Marketing  
BA (Hons) Film & Screen Arts

**T4.1**  
**T4.5**



3

BA (Hons) Costume Production & Associated Crafts  
BA (Hons) Fashion

**T3.10**  
**T3.11**



2

BA (Hons) Digital Media Production  
BA (Hons) Photography  
BA (Hons) Commercial Photography for Fashion, Advertising & Editorial

**T2.13**  
**T2.24**  
**T2.3/7**

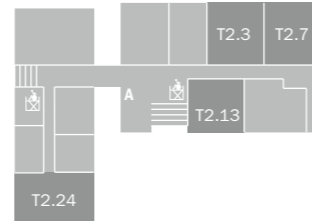

1

BA (Hons) Game Arts  
BA (Hons) Animation  
BA (Hons) Graphic Communication  
BA (Hons) Illustration

**T1.1/2**  
**T1.21**  
**T1.30**  
**T1.27/8**

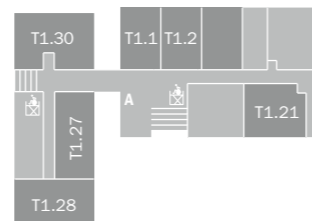

G

Students' Union  
Refectory  
Library/ Learning Lab/ Academic Support  
Plymouth Arts Cinema

**T0..1**  
**T0.5**  
**T0.18**  
**Cinema**

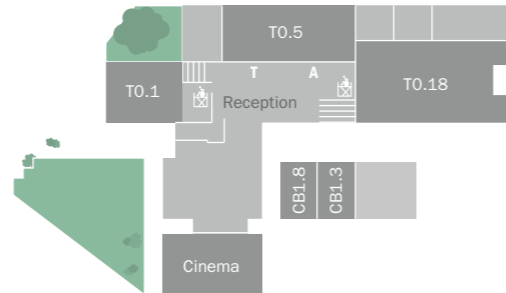

**ACCESS TO CHARLES CROSS BUILDING**

## KEY

- Stairs
- Disabled Access Lifts
- A** Accessible WC
- T** Gender Neutral Toilets
- Fab Lab
- Fabric Lab
- Imprint Lab
- Materials Lab
- Multimedia Lab



# CHARLES CROSS

2

BA (Hons) Printed Textile Design & Surface Pattern  
BA (Hons) Textile Practices

**CC2.12**  
**CC2.12**

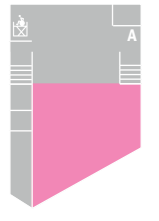

1

BA (Hons) Painting, Drawing & Printmaking

**CC2.01**

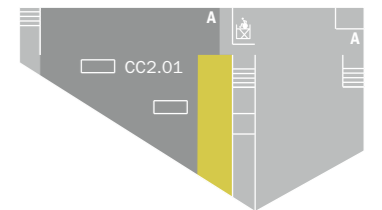

G

BA (Hons) Interior Decortion, Design & Styling  
Extended BA (Hons) Degrees  
BA (Hons) 3D Design Carfts

**T0.42**  
**T0.45**  
**CC1.0**

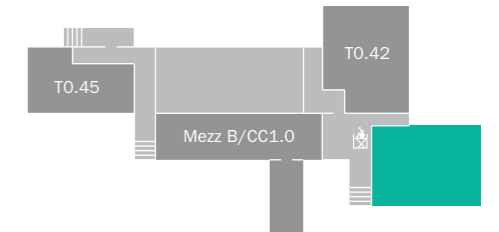

**ACCESS TO TAVISTOCK PLACE BUILDING**

LG

Design Crafts Studios  
Metals Studio

**CC0.01**  
**CC0.06**

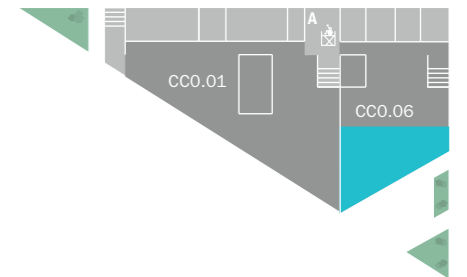

## STUDIO 11 / STUDIO 44

BA (Hons) Fine Art  
Postgraduate Courses

**Studio 11**  
**Studio 44**

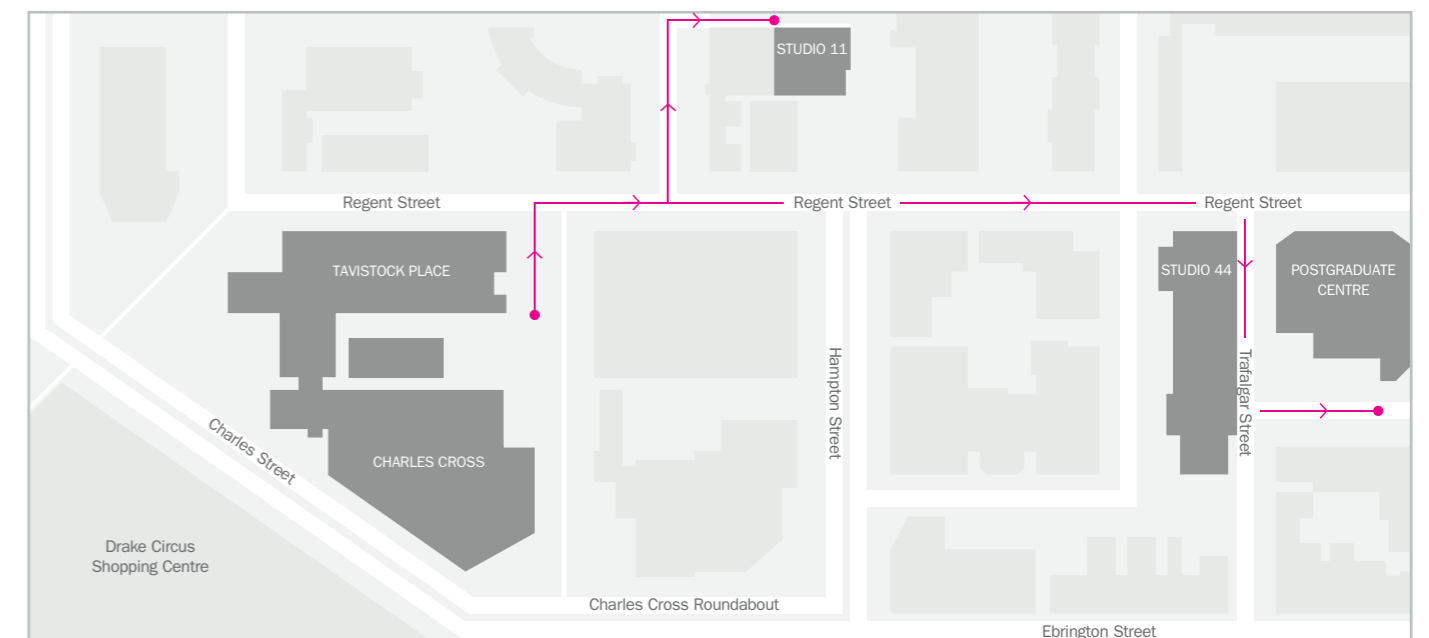

Disabled Access Routes